

Hampshire County Health Department On-Site Sewage Disposal System Inspection Form

Permit # **ST-14-12-117**

Name of Owner: Leonard W. Lowe Installer: Walter Fields
Address: 664 Shepherd Lane, Shepherdstown, WV 25443
Property Location: Shadow Knolls Lot 4 Lot Size: 20 acres Acres
Type of Facility: New Facility is: New Existing
Design Loading in gpd/# Bedrooms: 3 Source of Water: well

SEWAGE TANK COMPONENT

Capacity in Gallons: **1000** Material: precast concrete Pump Chamber gal
Distances (in feet) of Tank to: Dwelling NA
Private Public Water Source: NA Property Line: >100

ON-SITE DISPOSAL SYSTEM

Class I Systems: Standard Soil Trenches () or Bed () Gravelless Pipe (), Diameter In.
Chamber Soil Absorption Trenches () or Bed ()
Class II Systems: Pumped/Dosed Soil Absorption Trenches () or Bed () LPP ()
Evapotranspiration Trenches () or Bed ()
Shallow Soil Absorption Trenches () or Bed () Other:

No. of Lines: 3 Length (in feet): 60's
Width of Trenches: 36 inches/feet Depth to Bottom of Field: 24 inches
Size Equates to 900 sq ft of SGF
Distance (in feet) of System to: Dwelling NA
Private () Public () Water Source: NA Property Line: >100
Remarks: House or well not constructed at time of inspection.
GPS: N39 26 42.7 W78 37 26.4

An inspection indicates that
The sewage disposal system
Described above
DOES MEET
DOES NOT MEET or
CANNOT BE DETERMINED TO
MEET the minimum standards
Established by the West Virginia
Bureau of Public Health.
To correct a health hazard,
Modifications to existing systems
May be done to improve part of a
System. Such modifications may
Not be able to be designated as
a Does meet system since
Inadequate information is known.
Although many factors
Contribute to the successful
Functioning of a sewage disposal
System, this office recommends
Water conservation and
Maintaining an even usage of
Water throughout the week.

Visit Date(s): 7/13/2012

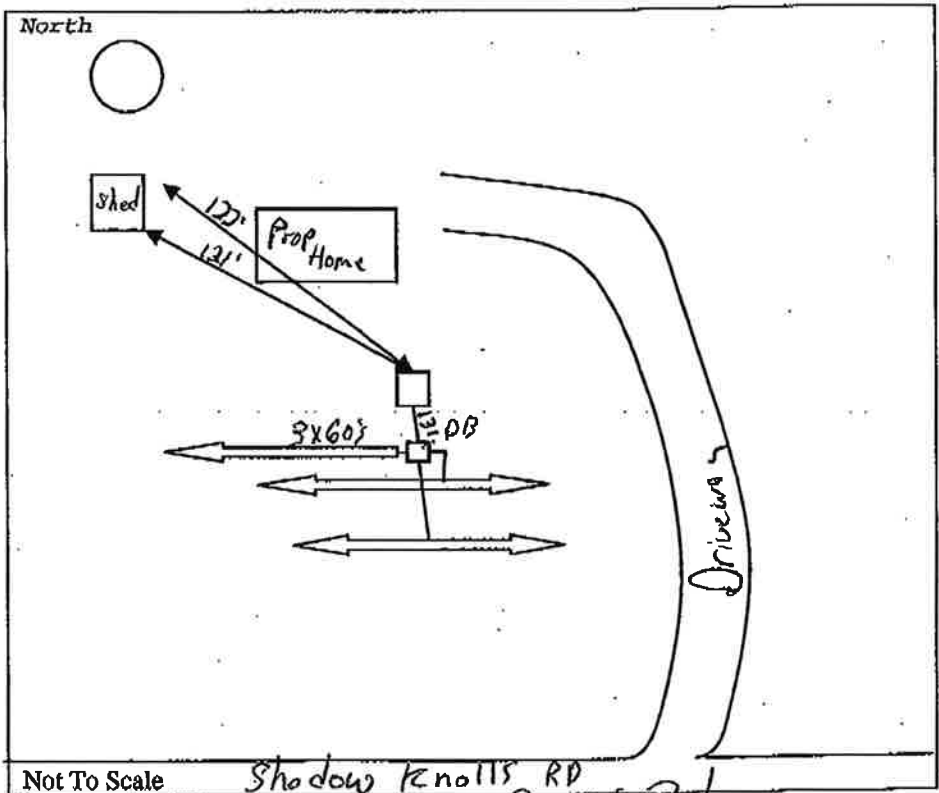

Not To Scale

Shadow Knolls RD

FINAL INSPECTION DATE: 7/13/2012

SANITARIAN: Dennis R. [Signature]