

# Soil Map

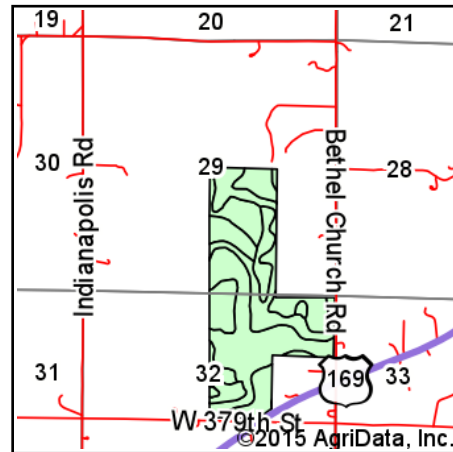

State: **Kansas**  
 County: **Miami**  
 Location: **32-18S-22E**  
 Township: **Mound**  
 Acres: **199**  
 Date: **5/6/2015**

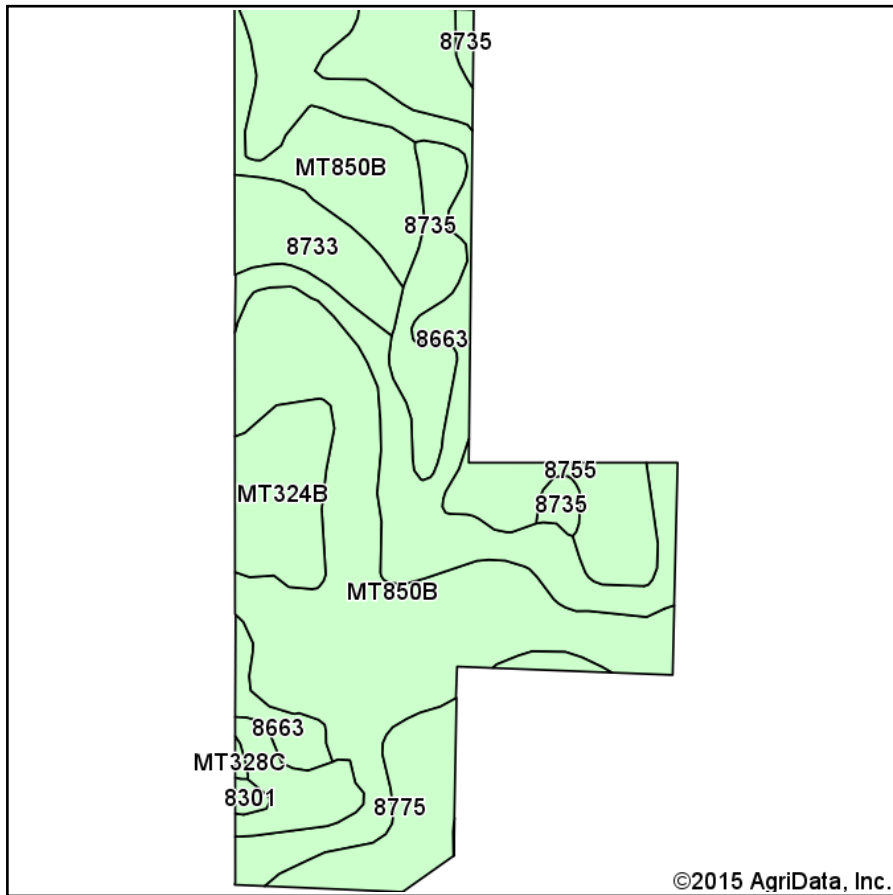

Maps Provided By:



Soils data provided by USDA and NRCS.

©2015 AgriData, Inc.

© AgriData, Inc. 2014 www.AgriDataInc.com

## Area Symbol: KS121, Soil Area Version: 15

Code	Soil Description	Acres	Percent of field	Non-Irr Class	Range Production (lbs/acre/yr)	Tall fescue	Alfalfa hay	Grain sorghum	Soybeans	Wheat	Improved bermudagrass	Smooth brome grass	Warm season grasses	Winter wheat
MT850B	Wagstaff silty clay loam, 1 to 3 percent slopes	76.62	38.5%	IIIe	6400								8	31
8663	Clareson-Rock outcrop complex, 3 to 15 percent slopes	43.40	21.8%	VIe	3000	3								
8755	Eram-Lebo silty clay loams, 5 to 20 percent slopes	21.56	10.8%	VIe	4500	5	2	28	16	16	4	1		
8735	Eram silty clay loam, 3 to 7 percent slopes	20.07	10.1%	IVe	4200	5					6			
8775	Kenoma silt loam, 1 to 3 percent slopes	13.30	6.7%	IIIe	3800									
MT324B	Bucyrus silty clay loam, 1 to 3 percent slopes	12.55	6.3%	Ile	6400								8	51
8733	Eram silty clay loam, 1 to 3 percent slopes	10.47	5.3%	IIIe	4000	6	3	45	25	25				
8301	Verdigris silt loam, 0 to 1 percent slopes, frequently flooded	0.74	0.4%	Vw	8126									
MT328C	Bucyrus silty clay loam, 3 to 8 percent slopes	0.29	0.1%	IIIe	0								8	51
<b>Weighted Average</b>					<b>4927.8</b>	<b>2</b>	<b>0.4</b>	<b>5.4</b>	<b>3</b>	<b>3</b>	<b>1</b>	<b>0.1</b>	<b>3.6</b>	<b>15.2</b>

Area Symbol: KS121, Soil Area Version: 15

Soils data provided by USDA and NRCS.