

Scale: 1" = 50'

LEGEND
 □ TELEPHONE PEDASTAL
 ⊙ POWER POLE
 -OHE- OVERHEAD ELECTRIC

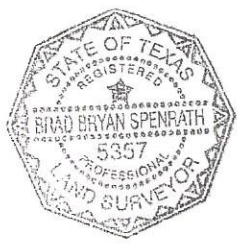

REFERENCES:
 VOLUME 10 PAGE 149-150 D.R.

NOTE:
 1) BASIS OF BEARING WAS ESTABLISHED FROM THE SOUTH LINE OF LOT 17 & 18 ON THE BELOW REFERENCED PLAT.
 PLAT SHOWING: ALL OF LOT 18 AND THE EAST ONE-HALF OF LOT 17, KELLER'S VELINO LODGE, RECORDED IN VOLUME 10, PAGES 149-150, DEED RECORDS, MASON COUNTY, TEXAS.

HILL COUNTRY LAND SURVEYING, LLC
 110 NORTH MILAM STREET
 FREDERICKSBURG, TEXAS 78624
 PHONE: (830) 990-2665

I HEREBY CERTIFY THAT THIS SURVEY WAS MADE ON THE GROUND, THAT THIS PLAT CORRECTLY REPRESENTS THE FACTS FOUND AT THE TIME OF THIS SURVEY AND THAT THERE ARE NO VISIBLE EASEMENTS OR ENCROACHMENT OF IMPROVEMENTS EXCEPT AS SHOWN HEREON.

Brad Bryan Spenrath
 BRAD BRYAN SPENRATH
 REGISTERED PROFESSIONAL LAND SURVEYOR
 # 5357
 TEXAS REGISTRATION NO.