

52 +/- Acres ~ Highway 11 ~ Leonard Area



Country Setting, wooded rolling terrain, with pastures, pond, and many nice homes sites. This piece of Texas has Electrical and Water Available and lots of road frontage. This is a gorgeous tract of land 4 miles from Hwy 121 and approximately 30 minutes to McKinney and about the same to Commerce. With Leonard schools and State Hwy frontage.



Contact:

Rodger Alexander
903/587-3301 Ext.103
972/658-2084 Cell
rodger@sretexas.com
www.sretexas.com

52 +/- Acres, Pond, Hwy Frontage, Trees, and Creek

SRE

**SUDDERTH
REAL
ESTATE**

52.8 Acres

Creek

Pond

11

11

County Road 4260

4260



©2007 Microsoft Corp.

©2007 NAVTEQ



SRE

**SUDDERTH
REAL
ESTATE**

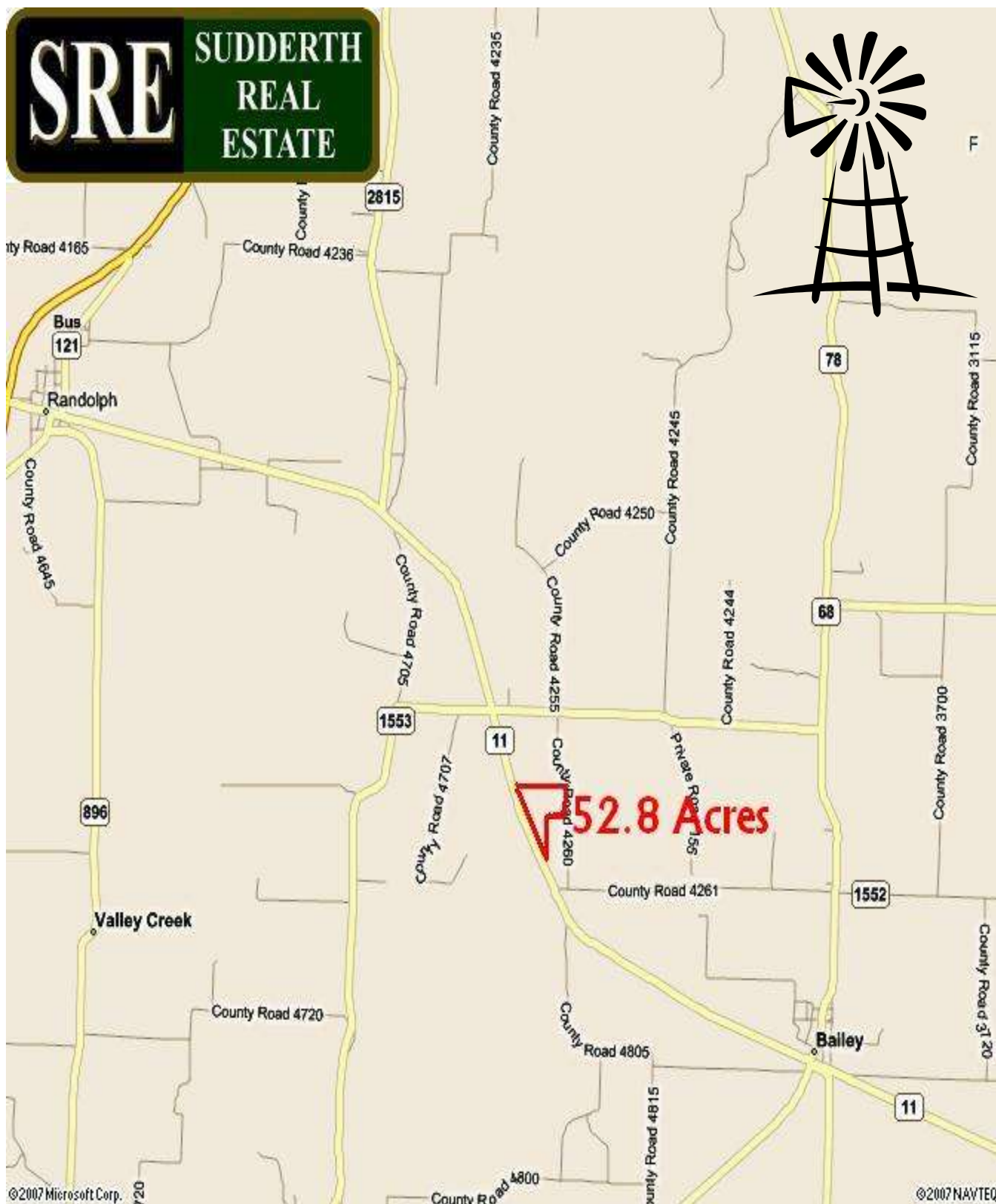

©2007 Microsoft Corp.

©2007 NAVTEQ

