

NOTE: No corner monuments were found or were set in the river or creek beds during the performance of this survey.

- LEGEND:**
- Denotes 5/8" Iron pin found for Property Corner, unless otherwise noted.
  - ⊙ Denotes 1/2" Iron pin set for Property Corner, unless otherwise noted.
  - ⊕ Denotes railroad spike set for Property Corner, unless otherwise noted.
  - Electric
  - - - - - Lullina between Tracts 34 & 35
  - ⋯ 60" Road Easement Lina

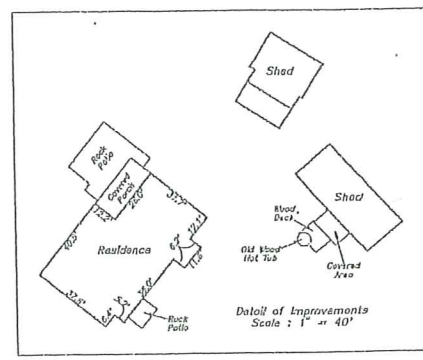
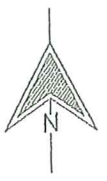

Line Table:

L1	N 30°21'50" E	279.68' (M) 220.00' (R)
L2	N 49°02'27" E	285.39' (M) 285.61' (R)
L3	N 34°50'57" E	146.29' (M) 140.51' (R)
L4	N 26°02'57" W	30.89' (M) 31.00' (R)
L5	N 09°44'09" W	219.52' (M) 219.84' (R)
L6	N 09°44'09" W	161.16' (M) 161.40' (R)
L7	N 09°44'09" W	168.59' (M) 168.63' (R)
L8	N 09°44'09" W	139.79' (M) 140.00' (R)
L9	N 09°44'07" W	231.70' (M) 232.04' (R)

**BASIS OF BEARINGS:**  
See drawing above.

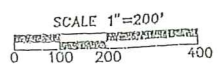

**LEGAL DESCRIPTION:**

Tract One: Being all of Tract No. Thirty-Four (34), Unit Two, Rancho Real Subdivision in Real County, Texas, according to the map or plat thereof, recorded in Volume 1, Pages 62 & 62A, Plat Records of Real County, Texas.

Tract Two: Being all of Tract No. Thirty-Five (35), Unit Two, Rancho Real Subdivision in Real County, Texas, according to the map or plat thereof, recorded in Volume 1, Pages 62 & 62A, Plat Records of Real County, Texas.

ADDRESS: 34 Rancho Rio

OWNER: Mary Elizabeth Galvan, Rebecca Galvan and Paul D. Farrell

**Restrictions/Easements/Setback Lines:**

Volume 1, Page 62 & 62A, Plat Records  
Volume 64, Page 183, Deed Records  
Volume 1, Page 67, Easement Records  
Volume 1, Page 164, Easement Records

Volume 1, Page 285, Easement Records  
Also see Title Commitment Estd.

**LAND SURVEYING & MAPPING**  
Professional Land Surveying

P. O. Box 1593  
Medina, Texas 78055  
(830) 460-4900

© 2003, Land Surveying & Mapping

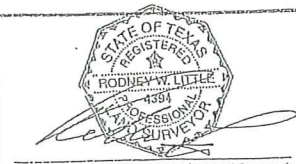

I, Rodney W. Little, Registered Professional Land Surveyor, do hereby certify that this survey was this day made on the ground of the property hereby described hereon, for on the attached plat, under my supervision, and there is no visible evidence of easements or encroachments shown. This plat correctly shows the location of easements, restrictions, and utility and limits of record filed in Real County, Texas, and Volume 1, P. 62, 62A, Easement Records dated 10/23/03.

**Boundary & Improvement Survey of**  
Tract 34 & Tract 35, Unit Two,  
Rancho Real Subdivision,  
Real County, Texas.

SCALE	1" = 200'	DATE	8/09/03	BY	R.W.L.
DATE	8/09/03	TITLE CO.	REAL COUNTY	FIELD WORK	8/08/03
G.F. #	0031003	DATE	8/09/03	REVISION	8/09/03
J.O. #	20030147	REVISED			