

MS - Adams Forest Home Rd 53 acres +/-

51.48 Acres
\$250,000.00



Brown Realty Co

Jerry Brown

(618) 728-9544

jbrown@brownrealtyco.com

<http://www.brownrealtyco.com>

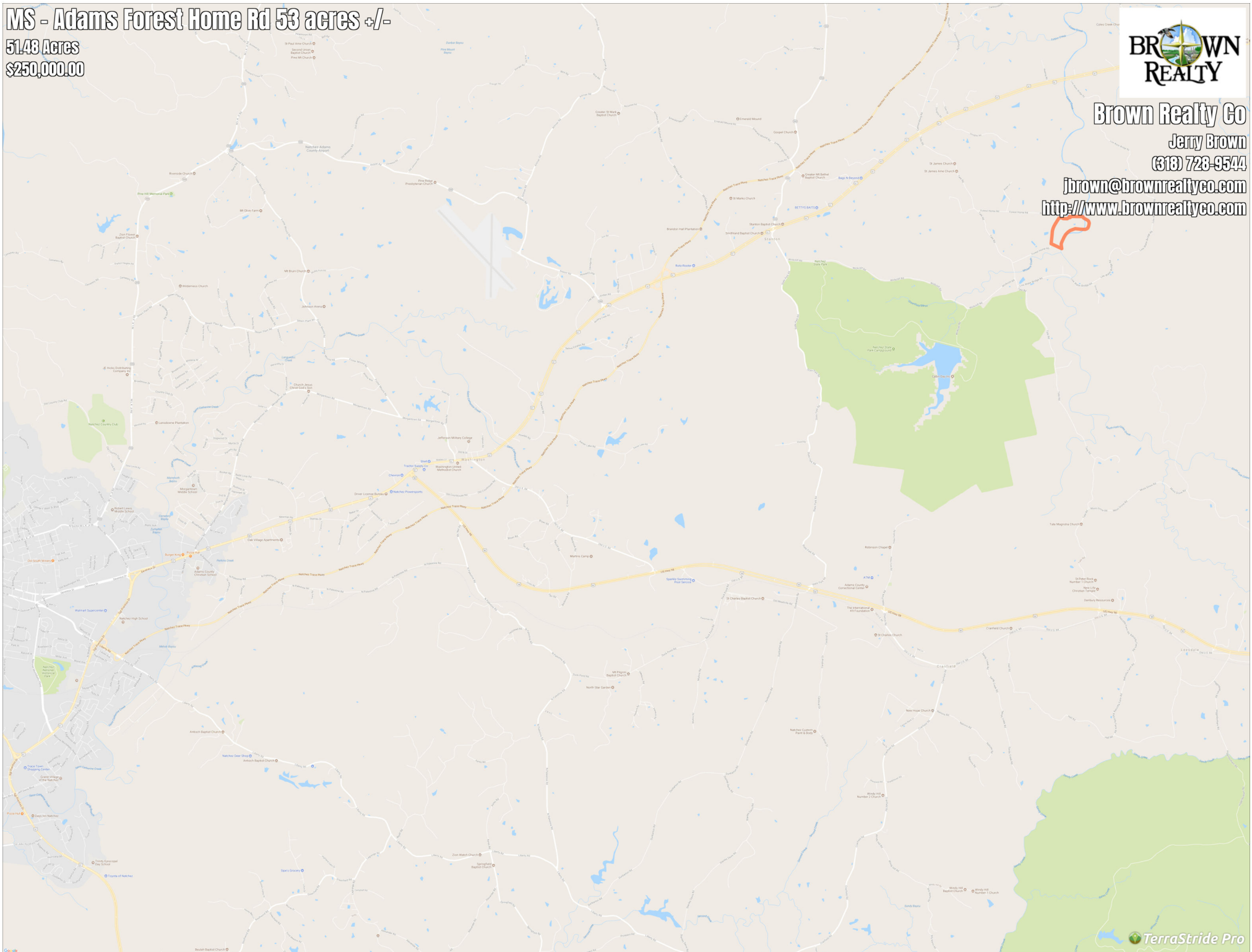

MS - Adams Forest Home Rd 53 acres +/-

Legend

 Boundary

Description

Only minutes out of Natchez, this property on Coles Creek is a must-see! Coles Creek forms the entire eastern boundary with over 1/2 mile of frontage the property offers great Adams County deer hunting and has produced some nice bucks. There are several food plots in place. The property is fenced for horses and currently includes a 2010 Southern States 3BD/2BA manufactured home. Brown Realty co Jerry Brown Broker 2189 hwy 425 Rayville LA 71269 318-728-9544

DISCLAIMER: The information contained herein is as obtained by this broker from sellers, owners, or other sources. This information is considered reliable, neither this broker nor owners make any guarantee, warranty or representation as to correctness of any data or descriptions and the accuracy of such statements. The correctness and / or accuracy of any and all statements should be determined through independent investigation made by the prospective purchaser. Any offer for sale is subject to prior sale, errors and omissions, change of price, terms or other conditions or withdrawal from sale in whole or in part, by seller without notice and at the sole discretion of seller. Readers are urged to form their own independent conclusions and evaluations in consultation with legal counsel, accountants, and/or investment advisors concerning and all material contained herein.

Generated on: Dec. 29, 2017