

For: Erin + Bethany McAtee

Notes

- 1) This is a HIGH INTENSITY SOILS INVESTIGATION.
- 2) This is a sketch map. The mapped areas are only generally located on this sketch. Pin flags were placed and measured in the field and must be found in place.
- 3) Keep fieldlines at least 20 feet off the edge of creek.

LEGEND

- MPI - estimated minutes per inch
- > - greater than
- ≥ - greater than or equal to
- DSW - Divert surface water
- - edge of creek

The signature of the Scientist does not constitute approval by the State Environmental Dept.

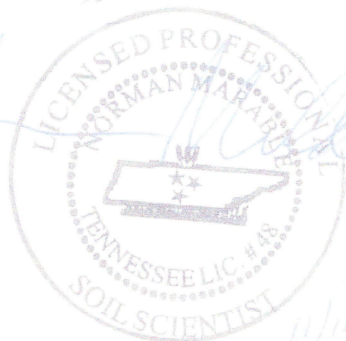

Norman Marable  
Soils Consultant  
P.O. Box 481  
Columbia, TN 38402

11/11/14

Haywood Hollow Rd

TO  
Gravel  
Hill  
RD

→ N

MAPPED AREAS  
SCALE  
1" = 100'

Bodine 0-15%  
45 MPI TO 26"  
Rock ≥ 36"

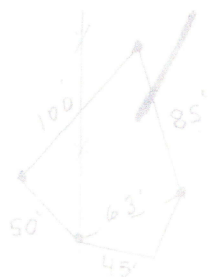

Dellrose 0-30%  
30 MPI TO 26"  
Rock ≥ 31"

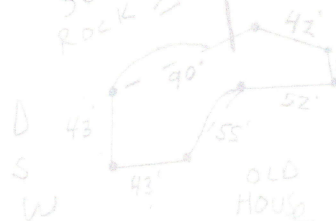

OLD FENCE ROW  
TOP OF HILL

FIELD  
CREEK