

LOGAN COUNTY

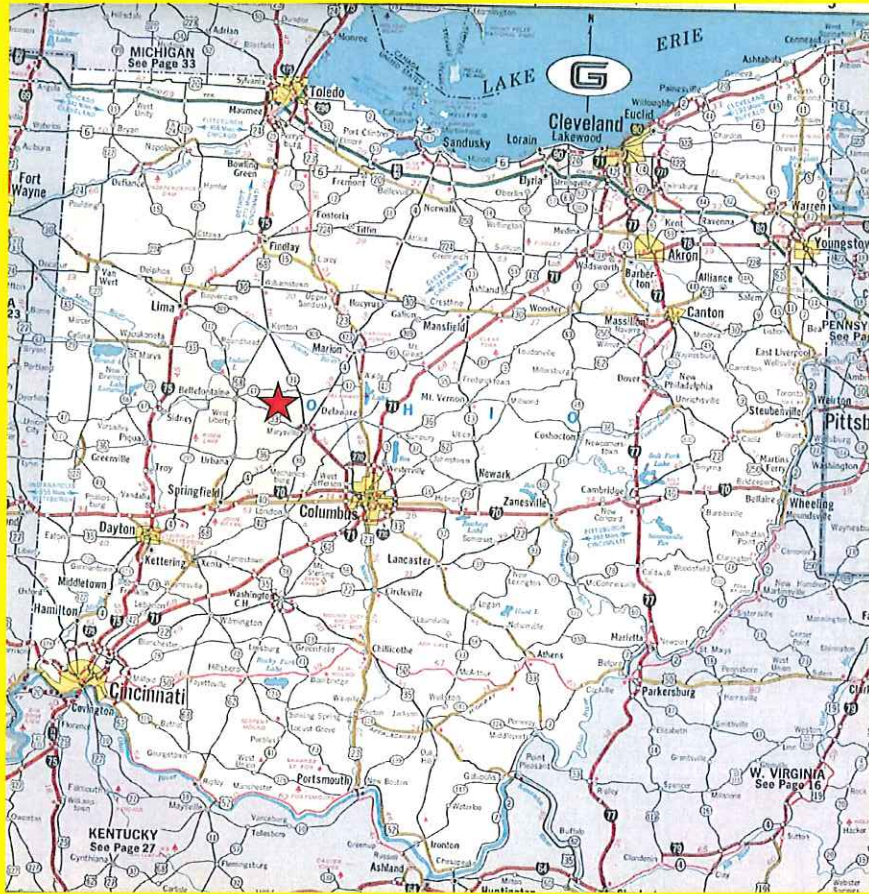

SKI LODGE VIEW!

Apx. 106 ac,
located on
S. CR 5.

Apx. 60 ac wooded, 46 ac tillable.

Inc. 3BR/2BTH log cabin home,
built 2010 &

2 car det. garage.

Benjamin Logan SD

Annual tax - \$3,900.58



419-228-8899

www.rsre.com

*Information deemed reliable
But not guaranteed*

\$1,100,000



RON SPENCER
419-230-1111

LOGAN COUNTY

subject

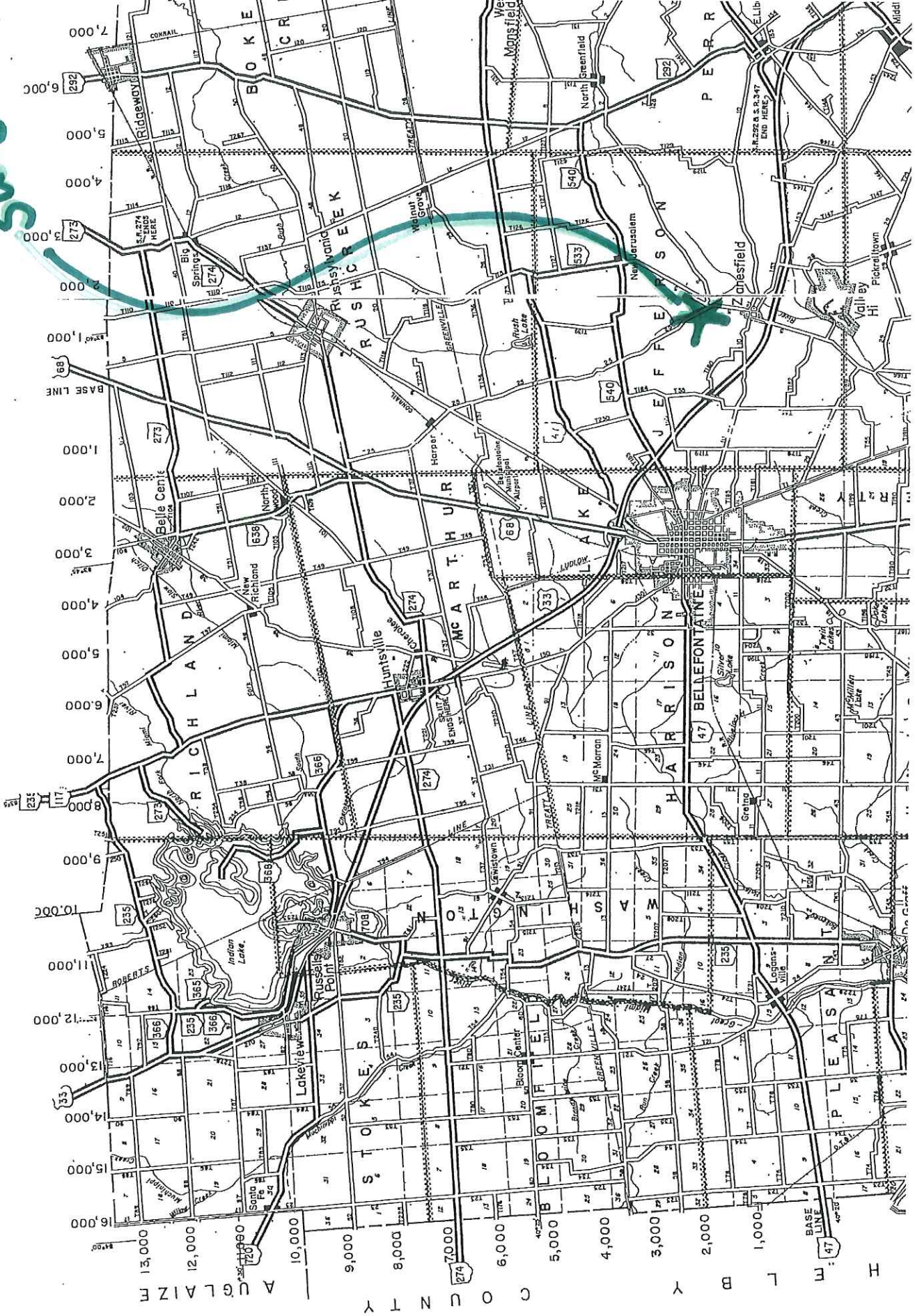

🔍 Address, Owner, or APN



2056 S CR



120940000048000





CROOKED TREE
FARM

est. 2008

