

CASS INN

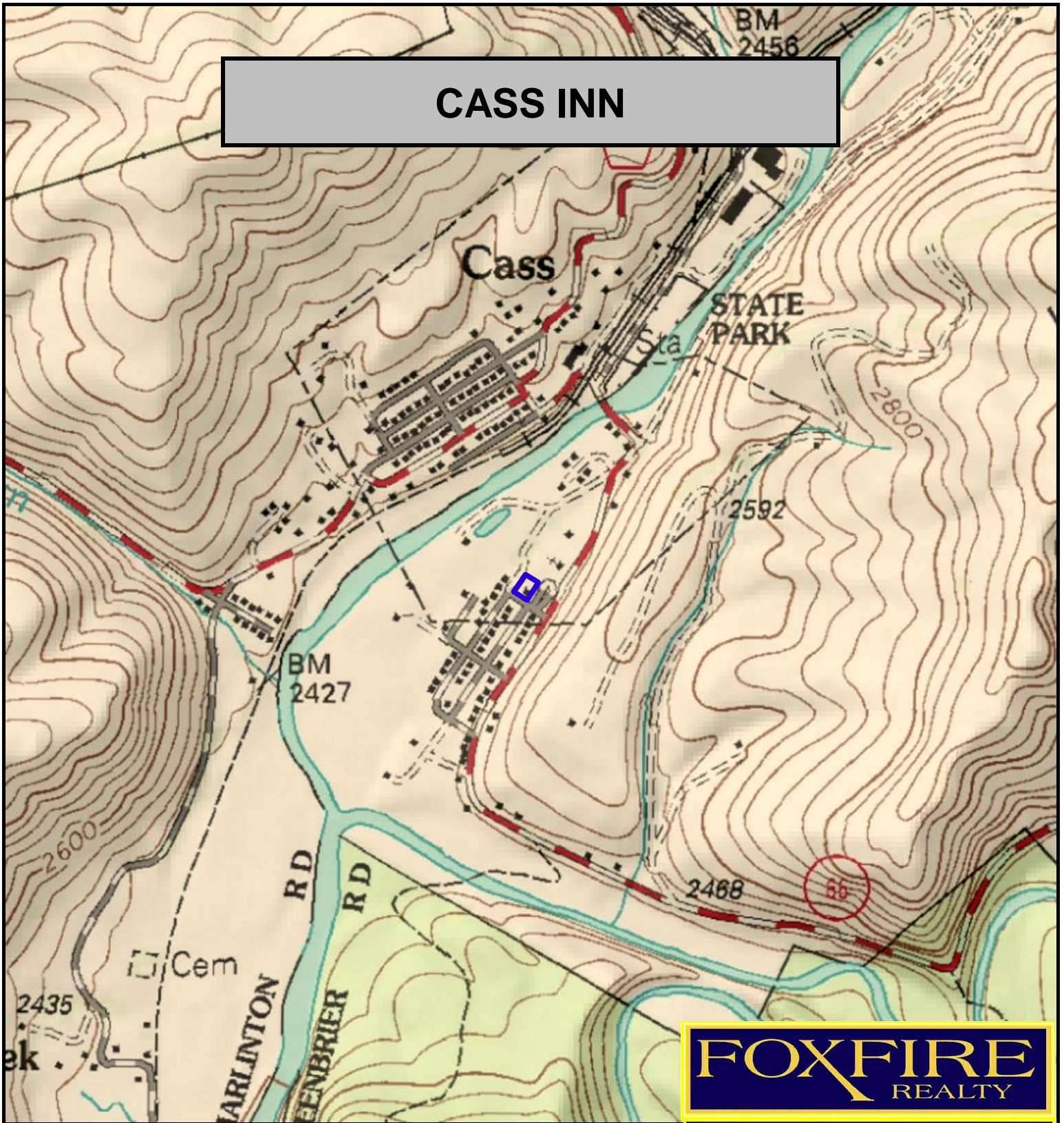

FOX FIRE
REALTY



CASS INN, Cass, Pocahontas County, WV (topographic map)
Elevation: 2424' +/-; Google Coordinates:
LAT 38.393237 (N), LON -79.915933 (W)
This map is for general location purposes only. Consult a licensed land
surveyor for actual boundary location and acreage.
Topo Map Scale: 1 inch = 800 feet

RICHARD GRIST, Broker - Auctioneer - Forester
304.646.8837 Richard@Foxfirenation.com
WWW.FOXFIRENATION.COM

SCALE 1:9600

