

SKETCH/AREA TABLE ADDENDUM

Case No 10/5/16

File No RP00127000040A

Property Address 56 N. BAKER ROAD

City SALMON

County LEMHI

State ID

Zip 83467

Borrower KOLMAN, JOE F. & ALICE C.

Lender/Client 56 N BAKER RD SALMON ID

L/C Address 16

Appraiser Name KF

Appr Address LEMHI

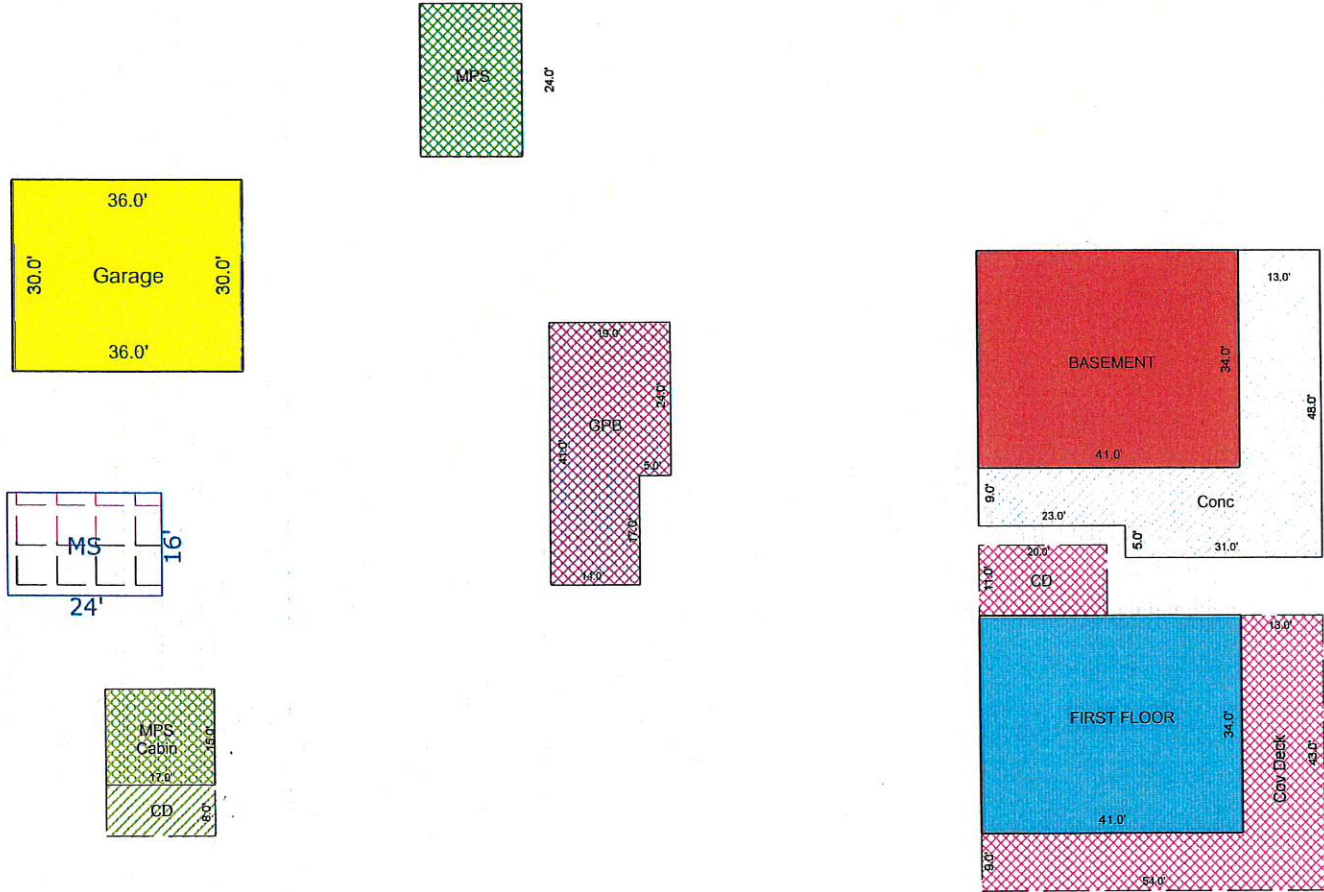

Scale: 1" = 12'

AREA CALCULATIONS SUMMARY

Code	Description	Net Size	Net Totals
GLA1	First Floor	1394.00	1394.00
BSMT	Basement	1394.00	1394.00
GAR	Garage	1080.00	1080.00
P/P	Cov Deck	928.00	
	Cov Deck	220.00	
	Cov Deck	136.00	1284.00
OTH	Concrete	1083.00	
	MPs	255.00	
	GPB	694.00	
	MPS	384.00	
	Mach Shed	384.00	2800.00

LIVING AREA BREAKDOWN

Breakdown	Subtotals
First Floor	
41.0 x 34.0	1394.00

Net LIVABLE Area

(rounded)

1394

1 Item

(rounded)

1394