

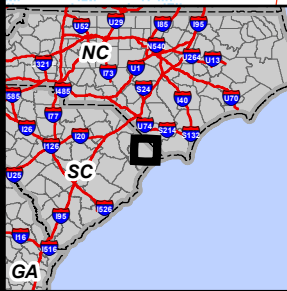

0 1,320 Feet

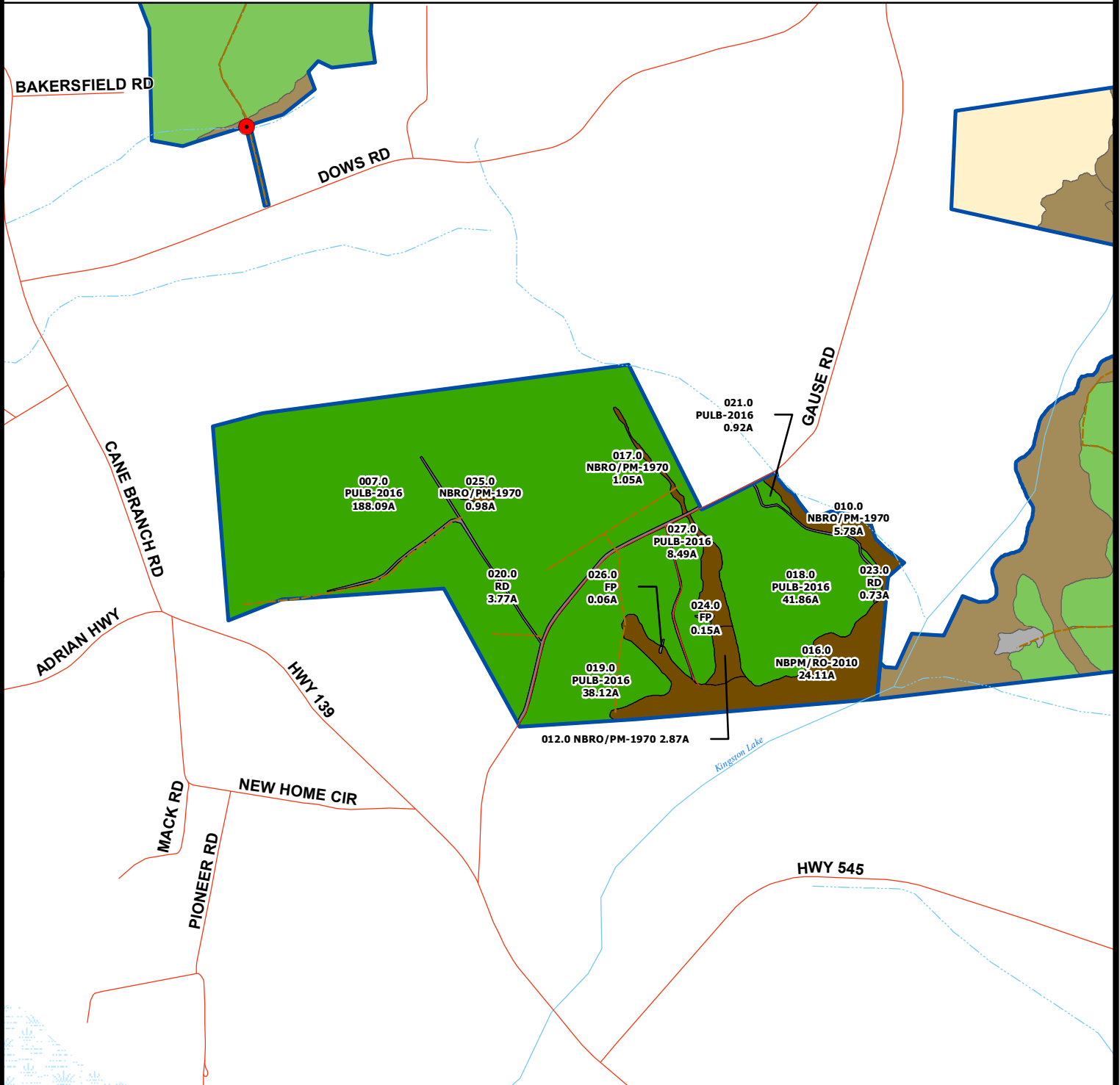

Stand Nomenclature	
Stand #	Stand Origin Codes
Description	P = Planted
Acres	N = Natural
	Land Type Codes
	B = Bottomland
	L = Lowland
	U = Upland
	O = Old Field
	S = Slope
Stand Origin	(N) (B) (MH) / (MP) - (74)
Land Type	
Dominant Species	
Secondary Species	
Year of Origin	

**Note:**

- Road polygons are not annotated
- Stand type acres report restricted to compartment area of interest
- Road data is not digitized & has been provided via ESRI data & maps 9.3.1 datasets.

Stand Types	
Gate	Natural Upland
Thinned	Non Forested
Cutover	Non Timbered (4.71 ac)
Natural Bottomland (38.67 ac)	Planted Lowland
Natural Irrigated	Planted Slope
Natural Lowland	Planted Upland (278.06 ac)
Natural Slope	

