

M60
45

N 14°25'43" W - 180.04

10 - ft (Unopened) Alley

Aerial Electric Line

Lot 24

LOT 22

Lot 20

S 75°38' W - 388.28

N 75°38' E - 388.25

Water Well

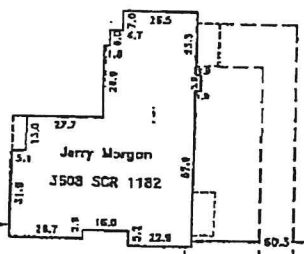
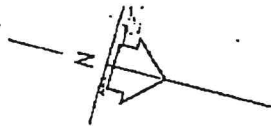

● = Found Bar 3/8" rebar
○ = Set 1/2" Rebar

N 14°26'26" W - 941.05

S 14°26'26" E - 180.03

NORTE DRIVE (SCR 1182)

John Wallis
Linda Rae Johnson

I hereby certify this is a true and correct plot of a survey made by me on the ground of Lot 22, Block 7, Del Norte Estates, an unrecorded plat of a 153.03-acre tract out of the E/2, Section 14, Block 39, T-2-S, T&P RR Co. Survey, Midland County, Texas, and being further described by metes and bounds as follows:

BEGINNING at a 3/8" rebar found at the NE corner of this tract and the NE corner of said Lot 22 in the west right-of-way line of South County Road 1182 (formerly known as Del Norte Drive), from which the NE corner of said Section 14 bears N 14 deg.26'26" W 941.05 feet and N 75 deg.15'19" E 1061.57 feet;

THENCE S 14 deg.26'26" E 180.03 feet with the east line of said Lot 22 and the west right-of-way line of South County Road 1182 (formerly known as Del Norte Drive) to a 1/2" rebar set at the SE corner of this tract and the SE corner of said Lot 22;

THENCE S 75 deg.38' W 388.28 feet with the south line of said Lot 22 to a 3/8" rebar found at the SW corner of this tract and the SW corner of said Lot 22;

THENCE N 14 deg.25'43" W 180.04 feet with the west line of said Lot 22 to a 3/8" rebar found at the NW corner of this tract and the NW corner of said Lot 22;

THENCE N 75 deg.38' E 388.25 feet with the north line of said Lot 22 to the POINT OF BEGINNING, containing 1.60 acres.

NOTE - The west ten (10) feet of this tract is reserved for an alley dedicated by the unrecorded plat of Del Norte Estates.

All bearings are grid, being related to north by GPS vectors through City of Midland Station "LAM20". Theta angle = -00 deg.53'49" (Texas Plane Coordinates Central Zone, NAD83).

John Wallis
Registered Professional Land Surveyor #2522
State of Texas



NE 1/4 Sec. 14
Blk. 39, T2S
T & P RR Co.

Survey Plat of Lot 22, Block 7, Del Norte Estates,
A Subdivision of a 153.03 acre Tract out of E/2 Section 14,
Block 39, T 2 S, T & P RR Co., Midland County, Texas

WALLIS LAND SURVEYORS

P.O. Box 4111 (915) 697-6816
Midland, TX 79704 Fax (915) 697-6817

DRAWING NUMBER: L22B7DNE.DWG		DISK: WS303	
SCALE: 1" = 40'	REVISION:	Drawing Number:	
DATE: 09-20-99		NO. B-09-20-99	
BY: AB			

SCANNED
AUG 24 2015